

MATENG

J63A SERIES

CATALOG

J63A SINGLE ROW SERIES MICRO RECTANGLE CONNECTORS



THE FEATURES OF THE PRODUCTS

- The space between this product's contacts is 0.635mm. It adopts twist pin. The size is small.
- Contacts number: It has 5, 9, 15, 21, 25, 31, 37, 51 cores.
- The wire's section area: 0.035mm.
- Plug and socket connecting method: It adopts screw thread to screw in, soft inserting and pulling, reliable locking.
- It is suitable for the connections of all kinds of electrical and circuitry which is high density, light, and highly reliable. It also meets the system needs of miniaturization and light duty.
- The plug equipped with twist pin, the socket equipped with jacks; The free side has lock screw, the fixation side has connecting nut.
- Execution standard: Q/FY QJ0007-2015
- «The detailed specification of J63 Double row series micro rectangular connector»
- Unmarked size tolerance is: ± 0.13

PERFORMANCE SPECIFICATION

Temperature	-5°C~+125°C	Contact resistance	$\leq 21 \text{ m}\Omega$
Vibration	10~2000Hz 196m/s ²	Insulation resistance	$\geq 5000 \text{ M}\Omega$ 100VDC
Shock	980m/s ² 6ms	Dielectrics voltage-resistance	250v
Rated current	1A	Endurance	500cycles
Random vibration	Power spectral density 0.4G ² /HZ. Total acceleration the root value of 23.1G		

CONTACT LAYOUT

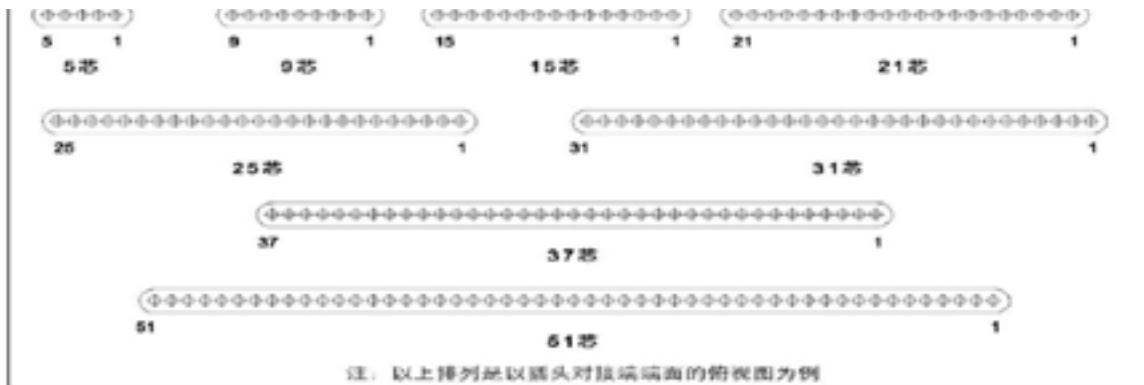

HOW TO ORDER

$\frac{J63A}{①}$ - $\frac{X}{②}$ $\frac{X}{③}$ $\frac{X}{④}$ - $\frac{XXX}{⑤}$ - $\frac{XX}{⑥}$ $\frac{X}{⑦}$ $\frac{XXX}{⑧}$

Main code name:	J63A	
The number of Contact's rows:	1-single row contacts	
The type of the products:	1	straight plug (crimp)
	2	straight socket(crimp)
	3	Horizontally mounted crimp plug
	4	Horizontally mounted crimp socket
	5	Vertically mounted crimp plug with tail cover
	6	Vertically mounted crimp socket with tail cover
	7	Horizontally mounted crimp plug with tail cover
	8	Horizontally mounted crimp socket with tail cover
	9	Vertically mounted crimp plug
	0	Vertically mounted crimp plug with tail cover
	A	Vertically surface mounted plug
	B	Vertically surface mounted socket
	C	Horizontally surface mounted plug
	D	Horizontally surface mounted socket
	E	Bending inserted PCB plug
	F	Bending inserted PCB socket
	G	Straight inserted PCB plug
	H	Straight inserted PCB socket
	J	Crimp connection
	U	Floating mounted crimp plug with guide column
	W	Crimp socket with guide hole

Shell plating:	2—Nickel plating 3—Stainless steel	
Contact number:	5,9,15,21,25,31,37,51 ect.	
Term of contact heading joint:	12	Horizontal/Vertical/surface mounted pin
	22	Horizontal/Vertical/surface mounted jack
	13	Straight inserted PCB pin. The length of the pin is 2.77mm
	23	Straight inserted PCB jack. The length of the pin is 2.77mm
	14	Straight inserted PCB pin. The length of the pin is 3.56mm
	24	Straight inserted PCB jack. The length of the pin is 3.56mm
	15	Straight inserted PCB pin. The length of the pin
	25	Straight inserted PCB jack. The length of the pin is 4.37mm
	16	Crimp pin
	26	Crimp jack
	32	Bending inserted PCB pin. The length of the pin is 2.77mm
	43	Bending inserted PCB jack. The length of the pin is 2.77mm
	33	Bending inserted PCB pin. The length of the pin is 3.56mm
	44	Bending inserted PCB jack. The length of the pin is 3.56mm
	34	Bending inserted PCB pin. The length of the pin is 4.37mm
	45	Bending inserted PCB jack. The length of the pin is 4.37mm
	pp	Plug connected with plug
	ps	Socket connected with socket
	ss	Socket connected with socked
Contact plating:	1—Gold plated	
Type of locking parts:	00	No locking parts
	JC	Locking screw (straight line groove)
	JC1	Locking screw(Hexagon)
	JC2	Locking screw(# 0-80UNF-2A)
	JC4	Locking screw(Phillips)
	TH	Coupling nut
	TH1	Coupling nut with guide function
	SH	Guide sleeve with welding function
	NH	Guide sleeve with nut mounted
	DZ	Guide column
	DK	Guide hole (lock parts can't be disassembled)

HOW TO CHOOSE PAIRED PRODUCTS

One side should have coupling nut (TH), another side should have locking screw (JC)

When choose the products with guide attachments, one side should have guide column, another side should have guide hole.

J63A SINGLE ROW SERIES MICRO RECTANGLE CONNECTORS

HOW TO ORDER

J63A — X X X — XXX — XX X XXX
 ① ② ③ ④ ⑤ ⑥ ⑦ ⑧

Main code name		J63A
Number of Contact's rows:		1 row
Type of the connectors:		1- Crimp plug
Shell plating:	2	Nickel plating
	3	Cadmium plating
	4	Stainless steel shell
Contact number:		005,009,015,021,025,031,037,051
Type of the contacts:	16	Crimp male pin
Contact plating:		1- Gold plated
Type of locking parts:	JC	Lock screw

BASIC FEATURES

- This connector is free side ,generally connected with socket which has coupling nut.
- Lock screw can't be disassembled ,it fixed on the shell.
- Straight line groove lock (JC) should be generally used. It can be tightened up with small straight screwdriver.



OVERALL DIMENSIONS

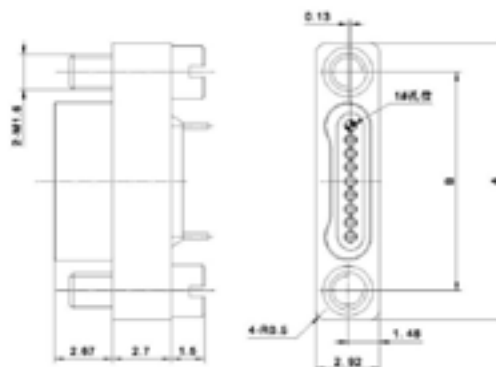

Type (Cores)	Size		Type (Cores)	Size		Type (Cores)	Size	
	A	B		A	B		A	B
5	10.16	7.49	9	12.7	10.03	15	16.51	13.84
21	20.32	17.65	25	22.86	20.19	31	26.67	24
37	30.48	27.81	51	39.37	36.7			

J63A CRIMP SOCKET WITH LOCK SCREW

HOW TO ORDER

$\frac{J63A}{①} - \frac{1}{②} \frac{2}{③} \frac{2}{④} - \frac{009}{⑤} - \frac{26}{⑥} \frac{1}{⑦} - \frac{JC}{⑧}$

Main code name		J63A
Number of Contact's rows:		1 row
Type of the connectors:		1 - Crimp plug
Shell plating:	2	Nickel plating
	3	Cadmium plating
	4	Stainless steel shell
Contact number:		005,009,015,021,025,031,037,051
Type of the contacts:	26	Crimp female pin
Contact plating:		1 - Gold plated
Type of locking parts:	JC	Lock screw

BASIC FEATURES

- This connector is free side ,generally connected with socket which has coupling nut.
- Lock screw can't be disassembled ,it fixed on the shell.
- Straight line groove lock (JC) should be generally used. It can be tightened up with small straight screwdriver.



OVERALL DIMENSIONS

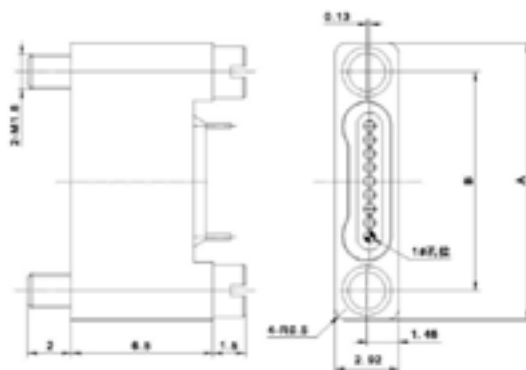

Type (Cores)	Size		Type (Cores)	Size		Type (Cores)	Size	
	A	B		A	B		A	B
5	10.16	7.49	9	12.7	10.03	15	16.51	13.84
21	20.32	17.65	25	22.86	20.19	31	26.67	24
37	30.48	27.81	51	39.37	36.7			

J63A VERTICALLY MOUNTED CRIMP SOCKET

HOW TO ORDER

$\frac{J63A}{①} - \frac{1}{②} \frac{2}{③} \frac{2}{④} - \frac{009}{⑤} - \frac{26}{⑥} \frac{1}{⑦} - \frac{TH}{⑧}$

Main code name		J63A
Number of Contact's rows:		1 row
Type of the connectors:		2—Crimp socket
Shell plating:	2	Nickel plating
	3	Cadmium plating
	4	Stainless steel shell
Contact number:		005,009,015,021,025,031,037,051
Type of the contacts:	26	Crimp female pin
Contact plating:		1- Gold plated
Type of locking parts:	TH	Coupling nut

BASIC FEATURES

- The coupling nut is general screw thread structure, the front part is tightened with lock nut and the back part is used for mounting.
- This connector generally connecting with plug with lock screw.



OVERALL DIMENSIONS

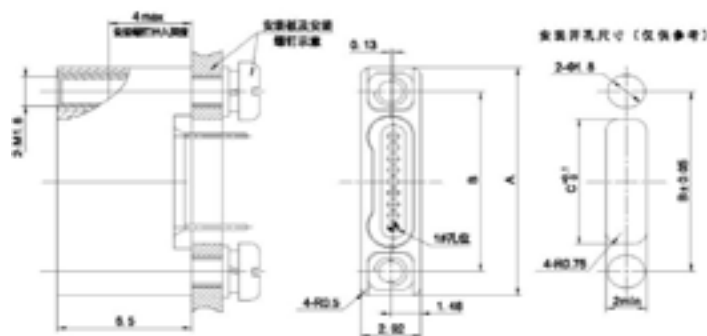

Type (Cores)	Size			Type (Cores)	Size			Type (Cores)	Size		
	A	B	C		A	B	C		A	B	C
5	10.16	7.49	3.3	9	12.7	10.03	5.8	16.51	13.84	13.84	9.6
21	20.32	17.65	13.4	25	22.86	20.19	16	26.67	24	24	19.8
37	30.48	27.81	23.6	51	39.37	36.7	32.5				

J63A SCREW MOUNTED CRIMP SOCKET WITH GUIDE HOLE

HOW TO ORDER

J63A — $\frac{1}{\textcircled{1}}$ $\frac{2}{\textcircled{2}}$ $\frac{2}{\textcircled{3}}$ $\frac{2}{\textcircled{4}}$ — $\frac{009}{\textcircled{5}}$ — $\frac{26}{\textcircled{6}}$ $\frac{1}{\textcircled{7}}$ — $\frac{\text{NH}}{\textcircled{8}}$

Main code name	J63A	
Number of Contact's rows:	1 row	
Type of the connectors:	2 - Crimp socket	
Shell plating:	2	Nickel plating
	3	Cadmium plating
	4	Stainless steel shell
Contact number:	005, 009, 015, 021, 025, 031, 037, 051	
Type of the contacts:	26	Crimp female pin
Contact plating:	1	Gold plated
Type of locking parts:	NH	Guide cover with nut mounted

BASIC FEATURES

— This connector has guide hole, it generally connecting with plug with lock screw.

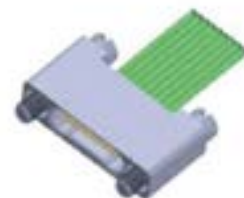

OVERALL DIMENSIONS

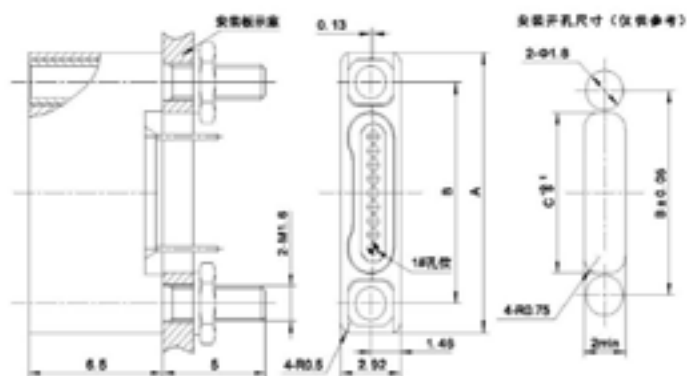

Type (Cores)	Size			Type (Cores)	Size			Type (Cores)	Size		
	A	B	C		A	B	C		A	B	C
5	10.16	7.49	3.3	9	12.7	10.03	5.8	15	16.51	13.84	9.6
21	20.32	17.65	13.4	25	22.86	20.19	16	31	26.67	24	19.8
37	30.48	27.81	23.6	51	39.37	36.7	32.5				

J63A HORIZONTALLY MOUNTED CRIMP PLUG

HOW TO ORDER

J63A — 1 3 2 — 009 — 16 1 — TH
 ① ② ③ ④ ⑤ ⑥ ⑦ ⑧

Main code name	J63A	
Number of Contact's rows:	1 row	
Type of the connectors:	3—Horizontally mounted plug	
Shell plating:	2	Nickel plating
	3	Cadmium plating
	4	Stainless steel shell
Contact number:	005, 009, 015, 021, 025, 031, 037, 051	
Type of the contacts:	26	Crimp male pin
Contact plating:	1- Gold plated	
Type of locking parts:	TH	Coupling nut

BASIC FEATURES

- This connector is vertically mounted as following diagram.
- This connector is generally connected with socket which has lock screw.



OVERALL DIMENSIONS

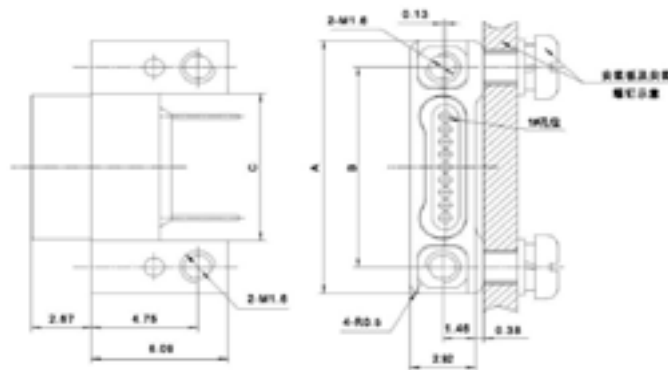

Type (Cores)	Size		Type (Cores)	Size		Type (Cores)	Size	
	A	B		A	B		A	B
5	10.16	7.49	9	12.7	10.03	15	16.51	13.84
21	20.32	17.65	25	22.86	20.19	31	26.67	24
37	30.48	27.81	51	39.37	36.7			

J63A CRIMP PLUG WITH TAIL COVER

HOW TO ORDER

J63A — 1 5 2 — 009 — 16 1 — JC
 ① ② ③ ④ ⑤ ⑥ ⑦ ⑧

Main code name	J63A	
Number of Contact's rows:	1 row	
Type of the connectors:	5	Mounted plug with tail cover
Shell plating:	2	Nickel plating
	3	Cadmium plating
	4	Stainless steel shell
Contact number:		005, 009, 015, 021, 025, 031, 037, 051
Type of the contacts:	16	Crimp male pin
Contact plating:	1	Gold plated
Type of locking parts:	JC	Lock screw

BASIC FEATURES

- This connector has one-piece cover tail which can't be removed. The shielding net is tightened on the cover tail ,so that the connector can be hole shielded.
- This connector is free side and not mounted,generally connected with socket which has coupling nut.
- Straight line groove lock (JC) should be generally used. It can be tightened up with small straight screwdriver.



OVERALL DIMENSIONS

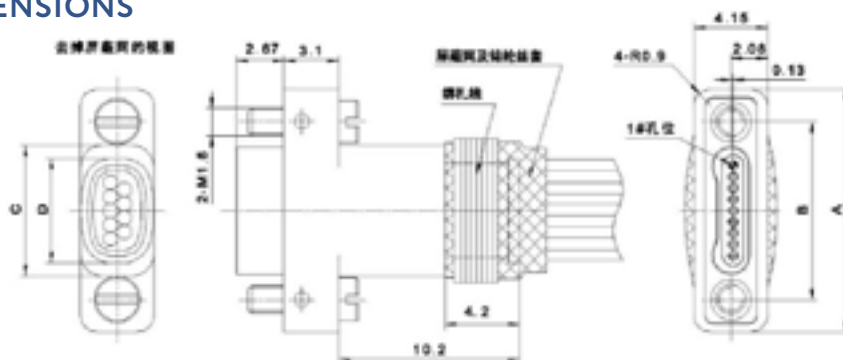

Type	Size				Type	Size				Type	Size			
(Cores)	A	B	C	D	(Cores)	A	B	C	D	(Cores)	A	B	C	D
5	10.5	7.49	4.67	3.17	15	13.7	10.03	7.2	5.7	15	17.51	13.84	11.01	9.51
21	21.32	17.65	14.82	13.32	31	23.86	20.19	17.36	15.86	31	27.67	24	21.17	19.67
37	31.48	27.81	24.98	23.48	65	40.37	36.7	33.87	32.37					

J63A CRIMP SOCKET WITH LOCK SCREW AND TAIL COVER

HOW TO ORDER

$\frac{J63A}{①}$ - $\frac{1}{②}$ $\frac{6}{③}$ $\frac{2}{④}$ - $\frac{009}{⑤}$ - $\frac{26}{⑥}$ $\frac{1}{⑦}$ - $\frac{JC}{⑧}$

Main code name	J63A		
Number of Contact's rows:	1 row		
Type of the connectors:	6	Crimp socket with tail cover	
Shell plating:	2	Nickel plating	
	3	Cadmium plating	
	4	Stainless steel shell	
Contact number:		005, 009, 015, 021, 025, 031, 037, 051	
Type of the contacts:	26	Crimp female pin	
Contact plating:	1	Gold plated	
Type of locking parts:	JC	Lock screw	



OVERALL DIMENSIONS

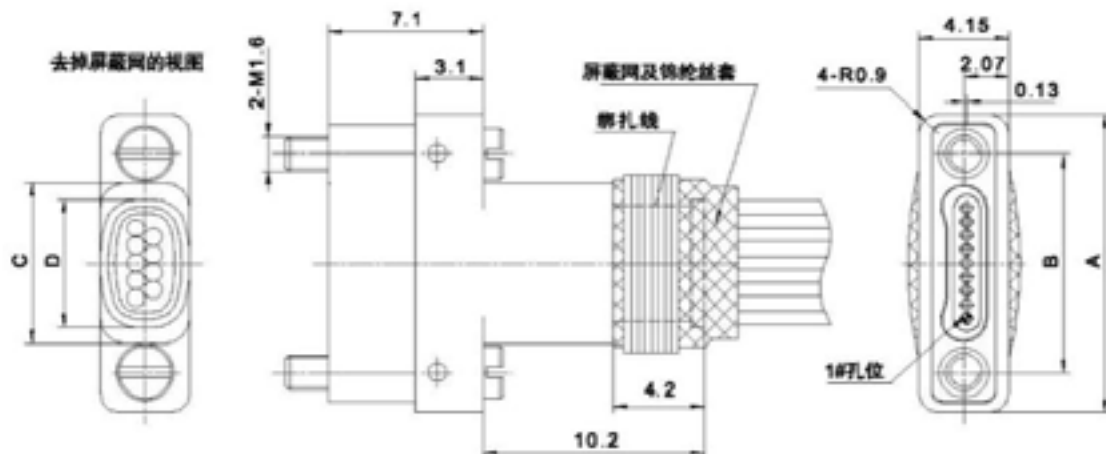

Type	Size				Type	Size				Type	Size			
(Cores)	A	B	C	D	(Cores)	A	B	C	D	(Cores)	A	B	C	D
5	10.5	7.49	4.67	3.17	15	13.7	10.03	7.2	5.7	15	17.51	13.84	11.01	9.51
21	21.32	17.65	14.82	13.32	31	23.86	20.19	17.36	15.86	31	27.67	24	21.17	19.67
37	31.48	27.81	24.98	23.48	65	40.37	36.7	33.87	32.37					

J63A VERTICALLY MOUNTED CRIMP SOCKET WITH TAIL COVER

HOW TO ORDER

J63A 1 6 2 009 26 1 TH
 ① ② ③ ④ ⑤ ⑥ ⑦ ⑧

Main code name	J63A		
Number of Contact's rows:	1 row		
Type of the connectors:	6	Crimp socket with tail cover	
Shell plating:	2	Nickel plating	
	3	Cadmium plating	
	4	Stainless steel shell	
Contact number:		005, 009, 015, 021, 025, 031, 037, 051	
Type of the contacts:	26	Crimp female pin	
Contact plating:	1	Gold plated	
Type of locking parts:	TH	Coupling nut	

BASIC FEATURES

- This connector has one-piece cover tail which can't be removed. The shielding net is tightened on the cover tail, so that the connector can be hole shielded.
- This connector is generally connected with plug which has lock screw.



OVERALL DIMENSIONS

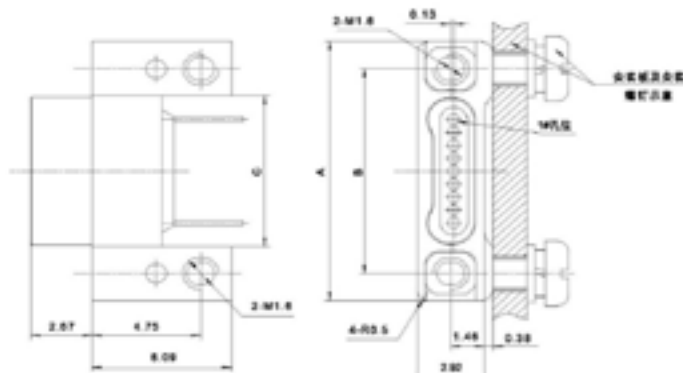

Type (Cores)	Size			Type (Cores)	Size			Type (Cores)	Size		
	A	B	C		A	B	C		A	B	C
5	10.16	7.49	4.84	9	12.7	10.03	7.38	15	16.51	13.84	11.19
21	20.32	17.65	15	25	22.86	20.19	17.54	31	26.67	24	21.35
37	30.48	27.81	25.16	51	39.37	36.7	34.05				

J63A HORIZONTALLY MOUNTED CRIMP PLUG WITH TAIL COVER

HOW TO ORDER

J63A – 1 7 2 – 009 – 16 1 – TH
 ① ② ③ ④ ⑤ ⑥ ⑦ ⑧

Main code name	J63A		
Number of Contact's rows:	1 row		
Type of the connectors:	7	Horizontally mounted crimp plug with tail cover	
Shell plating:	2	Nickel plating	
	3	Cadmium plating	
	4	Stainless steel shell	
Contact number:		005, 009, 015, 021, 025, 031, 037, 051	
Type of the contacts:	16	Crimp male pin	
Contact plating:	1	Gold plated	
Type of locking parts:	TH	Coupling nut	

BASIC FEATURES

- This connector has one-piece cover tail which can't be removed. The shielding net is tightened on the cover tail, so that the connector can be hole shielded
- This connector is horizontally mounted as following diagram.
- This is generally connects with socket which has lock screw.



OVERALL DIMENSIONS

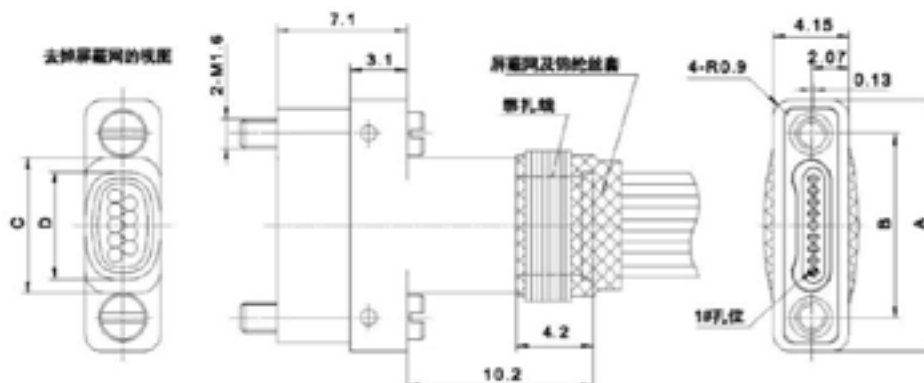

Type	Size				Type	Size				Type	Size			
(Cores)	A	B	C	D	(Cores)	A	B	C	D	(Cores)	A	B	C	D
5	11.16	7.49	4.67	3.17	15	13.7	10.03	7.2	5.7	15	17.51	13.84	11.01	9.51
21	21.32	17.65	14.82	13.32	31	23.86	20.19	17.36	15.86	31	27.67	24	21.17	19.67
37	31.48	27.81	24.98	23.48	65	40.37	36.7	33.87	32.37					

J63A VERTICALLY MOUNTED CRIMP SOCKET WITH TAIL COVER

HOW TO ORDER

J63A 1 6 2 009 26 1 TH
 ① ② ③ ④ ⑤ ⑥ ⑦ ⑧

Main code name	J63A	
Number of Contact's rows:	1 row	
Type of the connectors:	6	Crimp p with tail cover
Shell plating:	2	Nickel plating
	3	Cadmium plating
	4	Stainless steel shell
Contact number:	005, 009, 015, 021, 025, 031, 037, 051	
Type of the contacts:	26	Crimp male pin
Contact plating:	1	Gold plated
Type of locking parts:	TH	Coupling nut

BASIC FEATURES

- This connector has one-piece cover tail which can't be removed. The shielding net is tightened on the cover tail, so that the connector can be hole shielded.
- This connector is generally connected with plug which has lock screw.



OVERALL DIMENSIONS

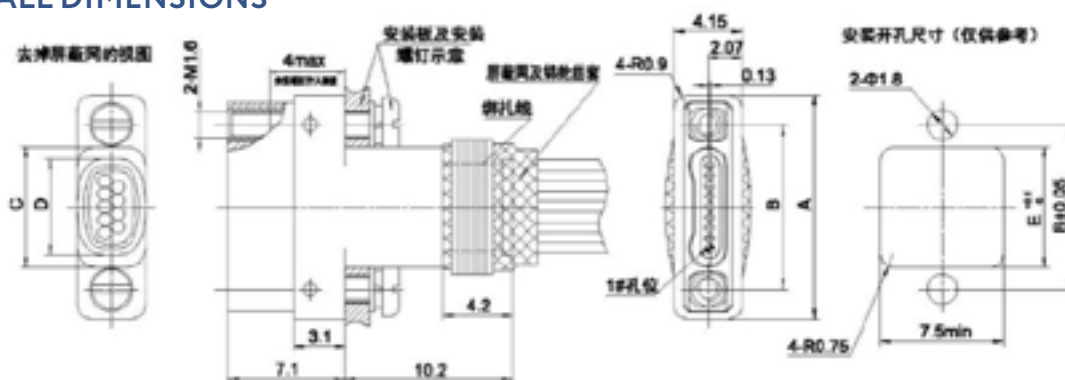

Type (Cores)	Size					Type (Cores)	Size				
	A	B	C	D	E		A	B	C	D	E
5	11.16	7.49	4.67	3.17	4.87	9	13.7	10.03	7.2	5.7	7.4
15	17.51	13.84	11.01	9.51	11.2	21	21.32	17.65	14.82	13.32	15
25	23.86	20.19	17.36	15.86	17.6	31	27.67	24	21.17	19.67	21.4
37	31.48	27.81	24.98	23.48	25.2	51	40.37	36.7	33.87	32.37	34.1

J63A FLOATING MOUNTED CRIMP SOCKET

HOW TO ORDER

$$\begin{array}{ccccccc} \text{J63A} & - & \text{1} & \text{U} & \text{2} & - & \text{009} & - & \text{16} & \text{1} & - & \text{00} \\ \text{①} & & \text{②} & \text{③} & \text{④} & & \text{⑤} & & \text{⑥} & \text{⑦} & & \text{⑧} \end{array}$$

Main code name	J63A	
Number of Contact's rows:	1 row	
Type of the connectors:	U	Floating mounted crimp plug
Shell plating:	2	Nickel plating
	3	Cadmium plating
	4	Stainless steel shell
Contact number:		005, 009, 015, 021, 025, 031, 037, 051
Type of the contacts:	16	Crimp male pin
Contact plating:	1	Gold plated
Type of locking parts:	TH	Coupling nut

BASIC FEATURES

- This connector has floating riveting tube and applies to blind side connectors.
- This connector generally connects with socket with guide hole.



OVERALL DIMENSIONS

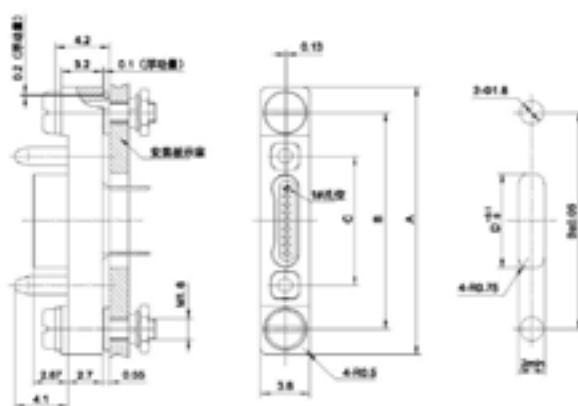

Type	Size				Type	Size				Type	Size			
(Cores)	A	B	C	D	(Cores)	A	B	C	D	(Cores)	A	B	C	D
5	18.26	14.26	7.49	3.3	15	20.8	16.8	10.03	5.8	15	24.61	20.61	13.84	9.6
21	28.42	24.42	17.65	13.4	31	30.96	29.96	20.19	6	31	34.77	30.77	24	19.8
37	8.58	34.58	27.81	23.6	65	47.47	43.47	36.7	32.5					

J63A FLANGE CRIMP SOCKET WITH GUIDE HOLE

HOW TO ORDER

$\frac{J63A}{①} - \frac{1}{②} \frac{W}{③} \frac{2}{④} - \frac{009}{⑤} - \frac{26}{⑥} \frac{1}{⑦} - \frac{00}{⑧}$

Main code name	J63A	
Number of Contact's rows:	1 row	
Type of the connectors:	W	Flange crimp mounted socket
Shell plating:	2	Nickel plating
	3	Cadmium plating
	4	Stainless steel shell
Contact number:		005, 009, 015, 021, 025, 031, 037, 051
Type of the contacts:	26	Crimp female contact
Contact plating:	1	Gold plated
Type of locking parts:	00	No lock parts

BASIC FEATURES

—This connector has guide hole and generally connects with plug which has guide column.



OVERALL DIMENSIONS

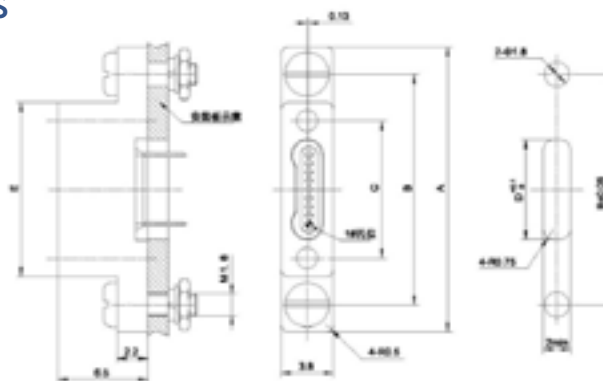

Type (Cores)	Size					Type (Cores)	Size				
	A	B	C	D	E		A	B	C	D	E
5	18.26	14.26	7.49	3.3	10.16	9	20.8	10.03	10.03	5.8	12.7
15	24.61	20.61	13.84	9.6	11.2	21	28.42	17.65	17.65	13.4	20.32
25	30.96	26.96	20.19	16	17.6	31	34.77	30.77	24	19.8	26.67
37	38.58	34.58	27.81	23.6	25.2	51	40.47	43.47	36.7	32.5	39.37

J63A FLOATING MOUNTED CRIMP SOCKET

HOW TO ORDER

J63A — 1 A 2 — 009 — 12 1 — TH
 ① ② ③ ④ ⑤ ⑥ ⑦ ⑧

Main code name	J63A	
Number of Contact's rows:	1 row	
Type of the connectors:	A	Vertically surface mounted plug
Shell plating:	2	Nickel plating
	3	Cadmium plating
	4	Stainless steel shell
Contact number:	005, 009, 015, 021, 025, 031, 037, 051	
Type of the contacts:	12	Vertically surface mounted male contact
Contact plating:	1	Gold plated
Type of locking parts:	TH	Coupling nut
	DZ	Guide column

BASIC FEATURES

- This connector adopts SMT welding technology.
- **J63A-1A2-009-121-TH** generally connects with socket which has lock screw
- **J63A-1A2-009-121-DZ** generally connects with socket which has guide hole (or guide column).
- Be careful to protect the pin cause it can be out of shape easily.

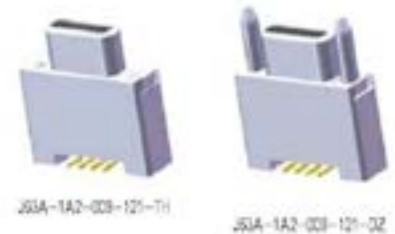

OVERALL DIMENSIONS

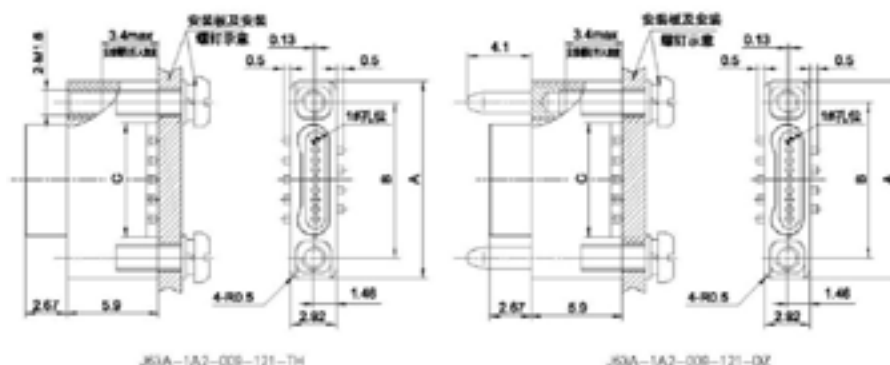

Type (Cores)	Size			Type (Cores)	Size			Type (Cores)	Size		
	A	B	C		A	B	C		A	B	C
5	10.16	7.49	4.84	9	12.7	10.03	7.38	15	16.51	13.84	11.19
21	20.32	17.65	15	25	22.86	20.19	17.54	31	26.67	24	21.35
37	30.48	27.81	25.16	51	39.37	36.7	34.05				

PCB PACKAGE SIZE (FOR REFERENCE ONLY)

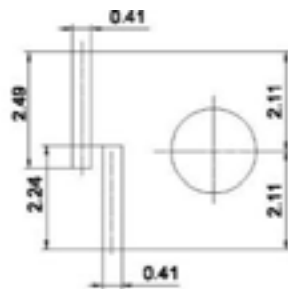

引脚封装尺寸局部放大图

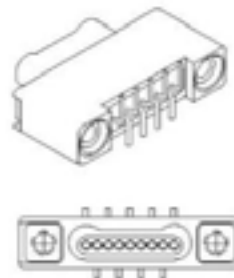

J63A-1A2-005-121-TH

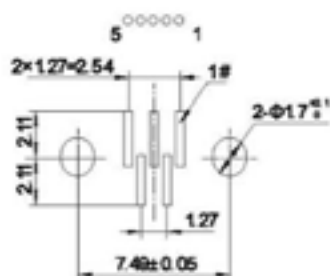

J63A-1A2-009-121-TH

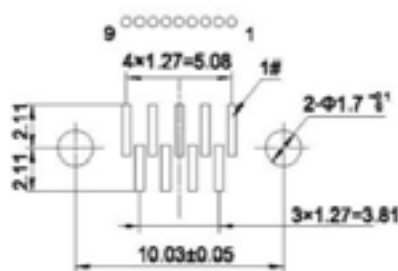

J63A-1A2-015-121-TH

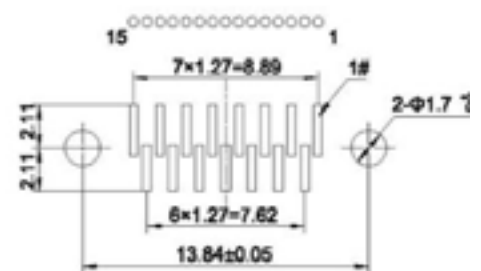

J63A-1A2-021-121-TH

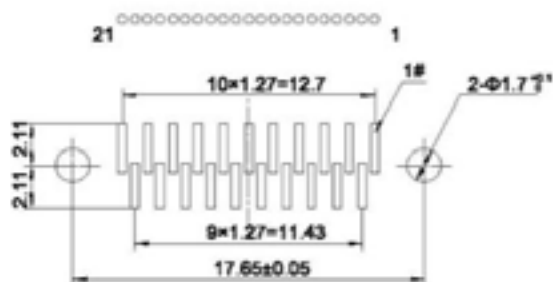

J63A-1A2-025-121-TH

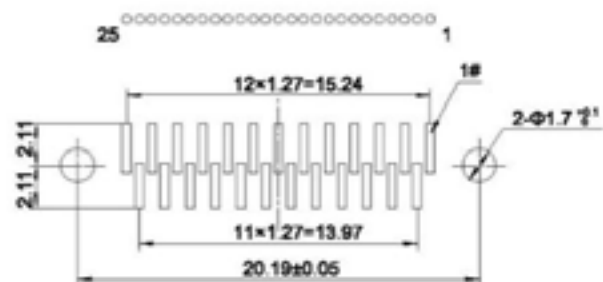

J63A-1A2-031-121-TH

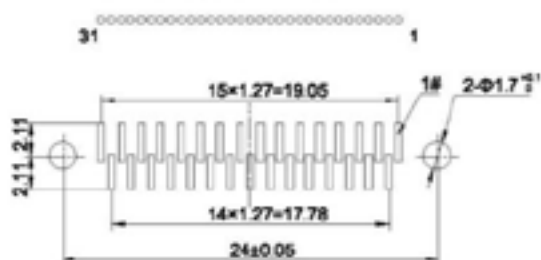

J63A-1A2-037-121-TH

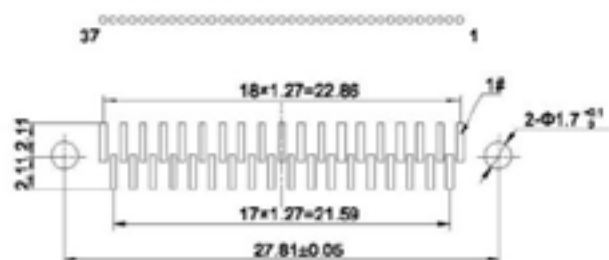

J63A-1A2-051-121-TH

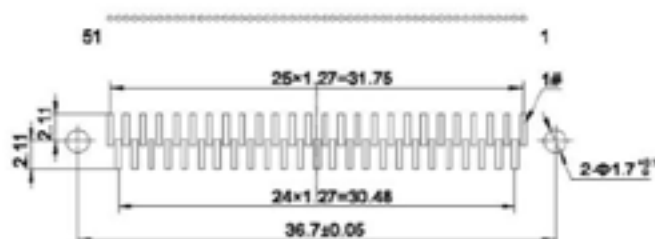

J63A VERTICALLY SURFACE MOUNTED SOCKET

HOW TO ORDER

$\frac{\text{J63A}}{\text{①}} - \frac{1}{\text{②}} \frac{\text{B}}{\text{③}} \frac{2}{\text{④}} - \frac{009}{\text{⑤}} - \frac{22}{\text{⑥}} \frac{1}{\text{⑦}} - \frac{\text{TH}}{\text{⑧}}$

Main code name	J63A	
Number of Contact's rows:	1 row	
Type of the connectors:	B	Vertically surface mounted socket
Shell plating:	2	Nickel plating
	3	Cadmium plating
	4	Stainless steel shell
Contact number:	005, 009, 015, 021, 025, 031, 037, 051	
Type of the contacts:	22	Vertically surface mounted female contact
Contact plating:	1	Gold plated
Type of locking parts:	TH	Coupling nut
	NH	Guide column

BASIC FEATURES

- This connector adopts SMT welding technology.
- **J63A-1B2-009-221-TH** generally connects with plug which has lock screw.
- **J63A-1B2-009-221-NH** generally connects with plug which has guide column.
- Be careful to protect the pin cause it can be out of shape easily.

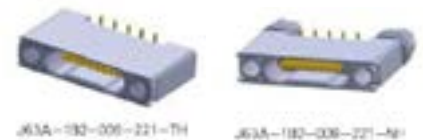

OVERALL DIMENSIONS

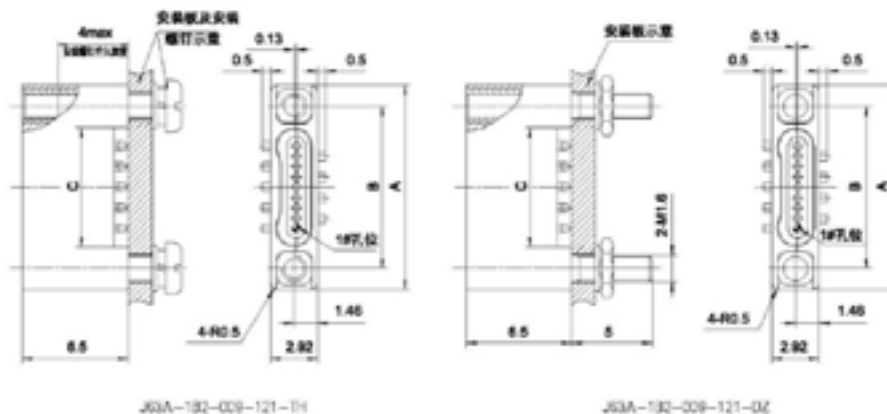

Type (Cores)	Size			Type (Cores)	Size			Type (Cores)	Size		
	A	B	C		A	B	C		A	B	C
5	10.16	7.49	4.84	9	12.7	10.03	7.38	15	16.51	13.84	11.19
21	20.32	17.65	15	25	22.86	20.19	17.54	31	26.67	24	21.35
37	30.48	27.81	25.16	51	39.37	36.7	34.05				

PCB PACKAGE SIZE (FOR REFERENCE ONLY)

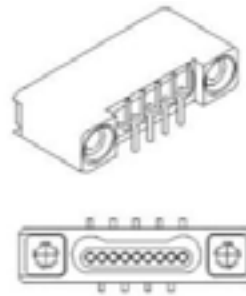
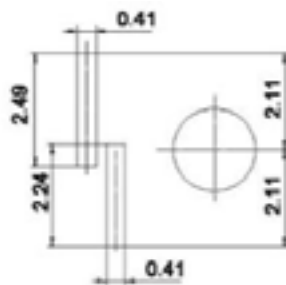

引脚封装尺寸局部放大图

J63A-1B2-005-121-TH

J63A-1B2-009-121-TH

J63A-1B2-015-121-TH

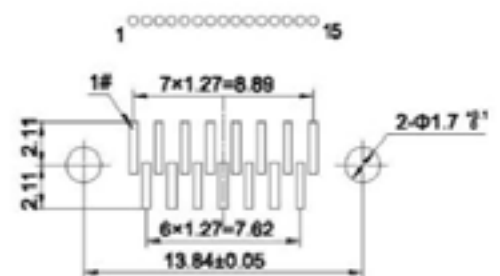
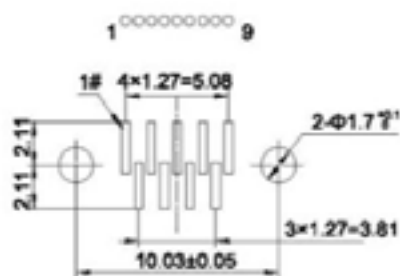
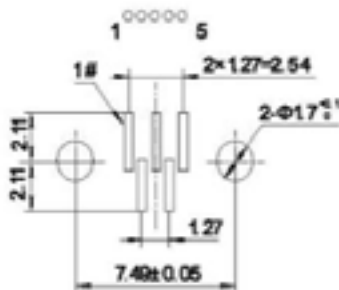

J63A-1B2-021-121-TH

J63A-1B2-025-121-TH

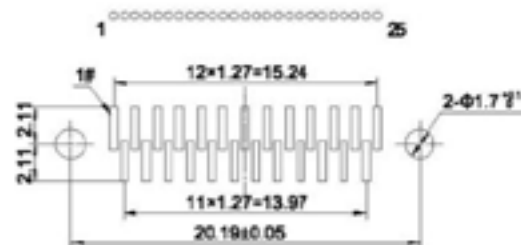
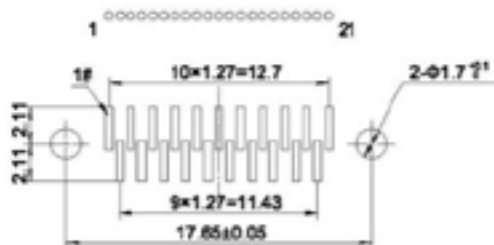

J63A-1B2-031-121-TH

J63A-1B2-037-121-TH

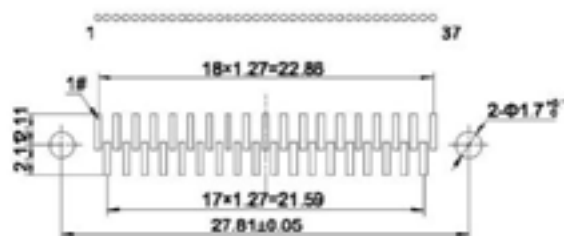
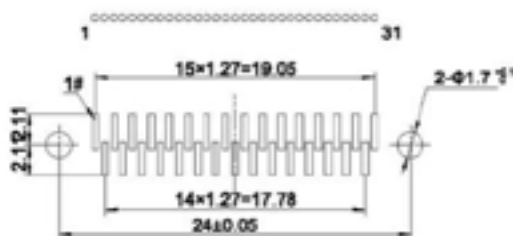

J63A-1B2-051-121-TH

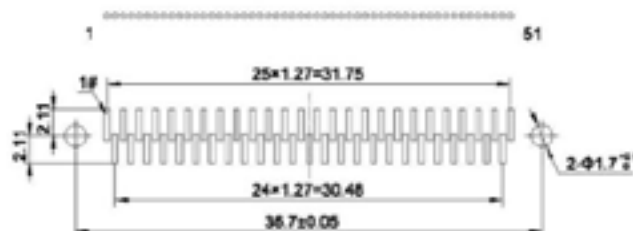

VERTICALLY SURFACE WELDING MOUNTED SOCKET

HOW TO ORDER

J63A — 1 B 2 — 009 — 22 1 — TH1
 ① ② ③ ④ ⑤ ⑥ ⑦ ⑧

Main code name	J63A		
Number of Contact's rows:	1 row		
Type of the connectors:	B	Vertically surface mounted socket	
Shell plating:	2	Nickel plating	
	3	Cadmium plating	
	4	Stainless steel shell	
Contact number:		005, 009, 015, 021, 025, 031, 037, 051	
Type of the contacts:	22	Vertically surface mounted female contact	
Contact plating:	1	Gold plated	
Type of locking parts:	TH1	Welding mounted coupling nut	
	SH	Welding mounted Guide column	

BASIC FEATURES

- This connector adopts SMT welding technology, it is suitable for the PCB which can not make a hole.
- **J63A-1B2-009-221-TH1** generally connects with plug which has lock screw
- **J63A-1B2-009-221-SH** generally connects with plug which has guide/column
- Be careful to protect the pin cause it can be out of shape easily.

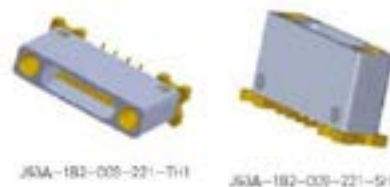

OVERALL DIMENSIONS

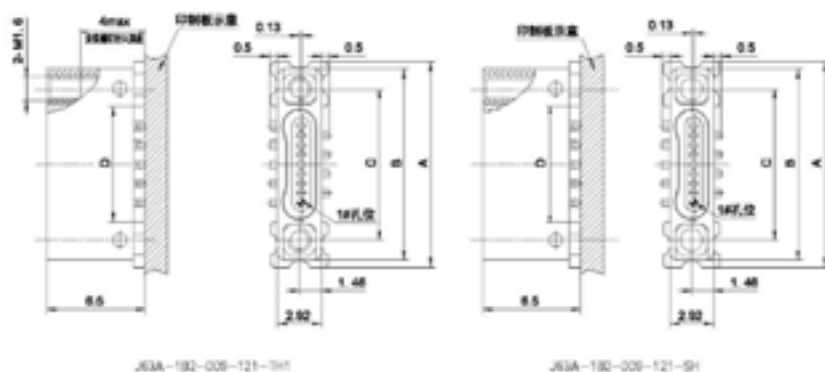

PCB PACKAGE SIZE (FOR REFERENCE ONLY)

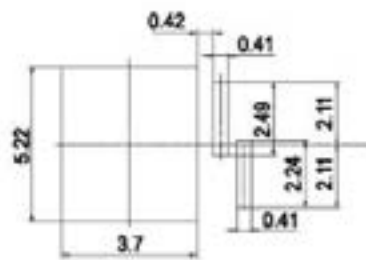

引脚封装尺寸局部放大图



J63A-1B2-005-121-TH1

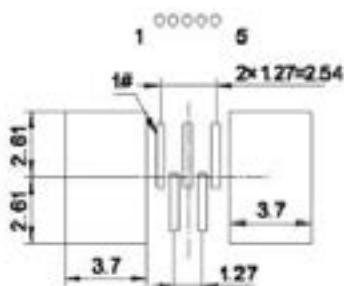

J63A-1B2-009-121-TH1



J63A-1B2-015-121-TH1

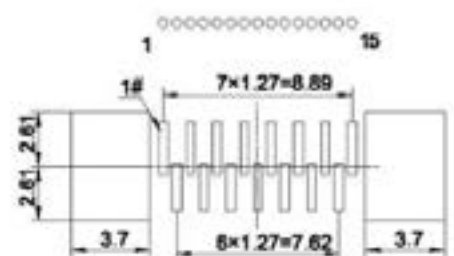

J63A-1B2-021-121-TH1

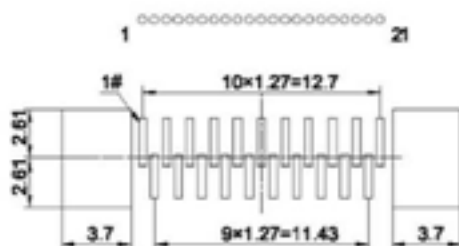

J63A-1B2-025-121-TH1

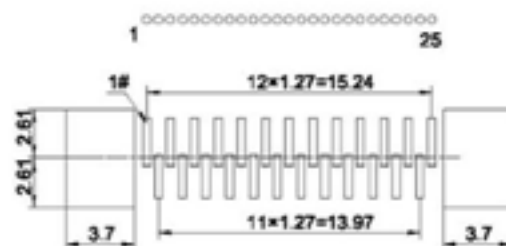

J63A-1B2-031-121-TH1

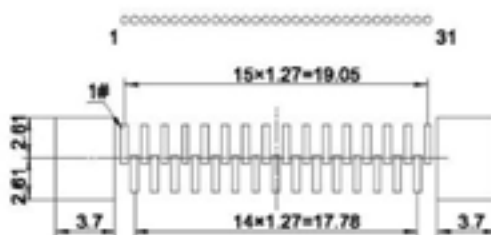

J63A-1B2-037-121-TH1

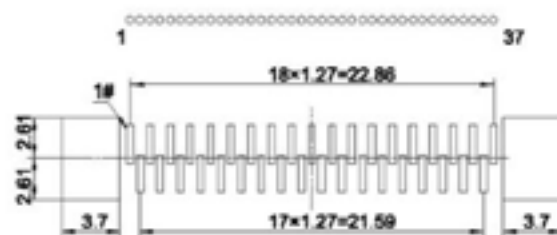

J63A-1B2-051-121-TH1

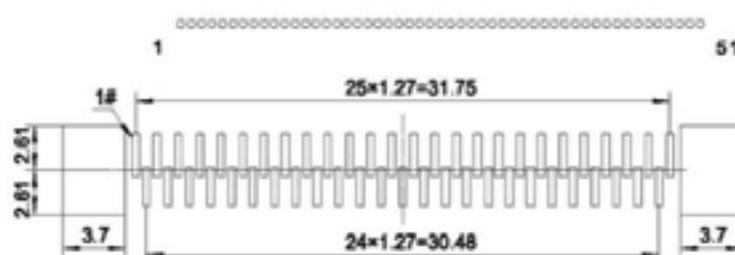

J63A HORIZONTALLY SURFACE MOUNTED SOCKET

HOW TO ORDER

J63A - 1 D 2 - 009 - 22 1 - TH
① ② ③ ④ ⑤ ⑥ ⑦ ⑧

Main code name	J63A	
Number of Contact's rows:	1 row	
Type of the connectors:	D	Horizontally surface mounted socket
Shell plating:	2	Nickel plating
	3	Cadmium plating
	4	Stainless steel shell
Contact number:		005, 009, 015, 021, 025, 031, 037, 051
Type of the contacts:	22	Horizontally surface mounted female contact
Contact plating:	1	Gold plated
Type of locking parts:	TH	Coupling nut

BASIC FEATURES

- This connector adopts SMT welding technology.
- This connector generally connects with socket which has lock screw.
- Be careful to use the pin which can be easily out of shape.

OVERALL DIMENSIONS

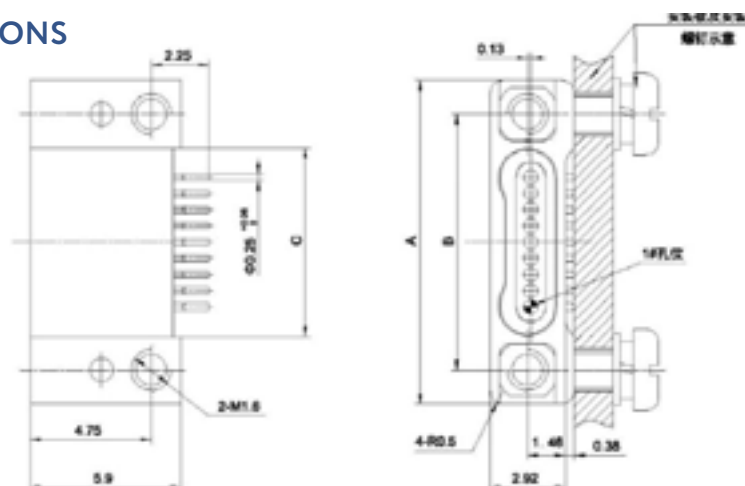

Type (Cores)	Size			Type (Cores)	Size			Type (Cores)	Size		
	A	B	C		A	B	C		A	B	C
5	10.16	7.49	4.84	9	12.7	10.03	7.38	15	16.51	13.84	11.19
21	20.32	17.65	15	25	22.86	20.19	17.54	31	26.67	24	21.35
37	30.48	27.81	25.16	51	39.37	36.7	34.05				

PCB PACKAGE SIZE (FOR REFERENCE ONLY)

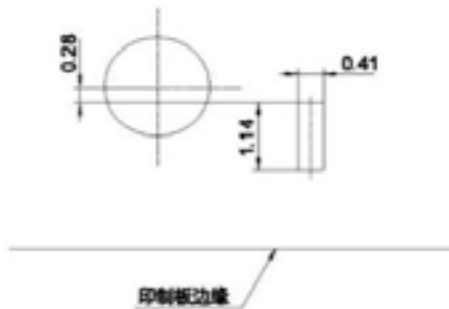

引脚封装尺寸局部放大图



J63A-1D2-005-121-TH

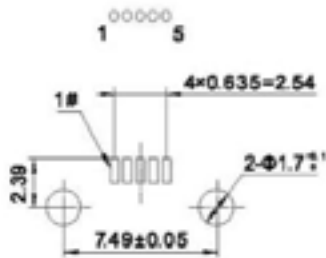

J63A-1D2-051-121-TH

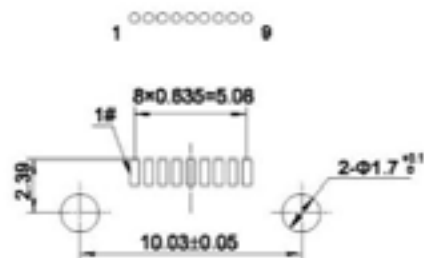

J63A-1D2-015-121-TH

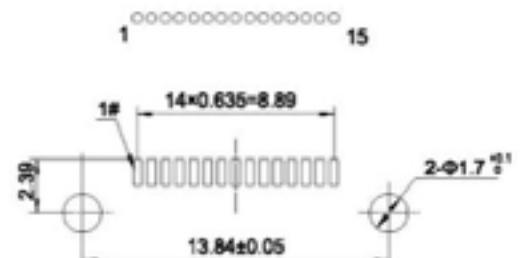

J63A-1D2-021-121-TH

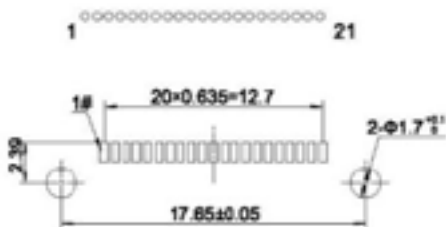

J63A-1D2-025-121-TH



J63A-1D2-031-121-TH

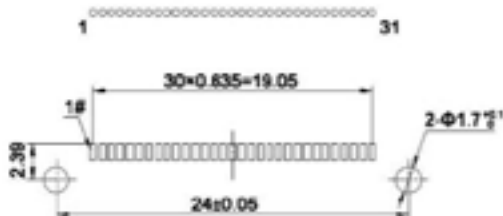

J63A-1D2-037-121-TH

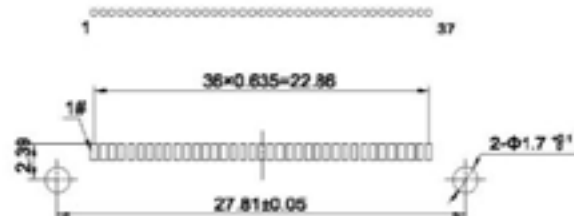

J63A-1D2-051-121-TH

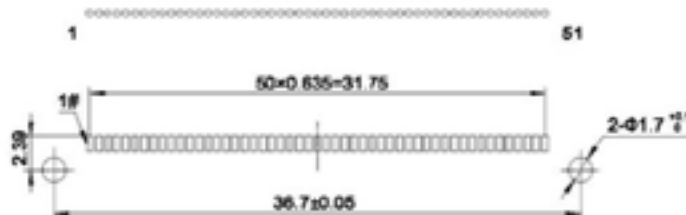

J63A BENDING INSERTED PCB PLUG

HOW TO ORDER

$\frac{\text{J63A}}{\textcircled{1}}$ - $\frac{1}{\textcircled{2}}$ $\frac{\text{E}}{\textcircled{3}}$ $\frac{2}{\textcircled{4}}$ - $\frac{009}{\textcircled{5}}$ - $\frac{32}{\textcircled{6}}$ $\frac{1}{\textcircled{7}}$ - $\frac{\text{TH}}{\textcircled{8}}$

Main code name	J63A	
Number of Contact's rows:	1 row	
Type of the connectors:	E	Right angle bending inserted plug
Shell plating:	2	Nickel plating
	3	Cadmium plating
	4	Stainless steel shell
Contact number:	005, 009, 015, 021, 025, 031, 037, 051	
Type of the contacts:	32	Bending inserted PCB male contact, the pin length is 2.77mm
	33	The pin length is 3.56mm
	34	The pin length is 4.37mm
Contact plating:	1	Gold plated
Type of locking parts:	TH	Coupling nut
	DZ	Guide column

BASIC FEATURES

- There are three specifications of the pin length, you have to customize the length which you need.
- J63A-1E1-009-321-TH** generally connects with socket which has lock screw.
- J63A-1E1-009-321-DZ** generally connects with socket which has guide hole (or guide cover)

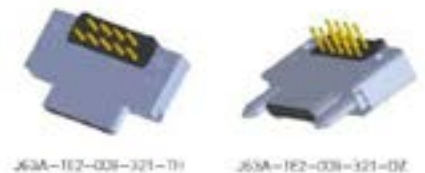

OVERALL DIMENSIONS

Type (Cores)	Size			Type (Cores)	Size			Type (Cores)	Size		
	A	B	C		A	B	C		A	B	C
5	10.16	7.49	4.84	9	12.7	10.03	7.38	15	16.51	13.84	11.19
21	20.32	17.65	15	25	22.86	20.19	17.54	31	26.67	24	21.35
37	30.48	27.81	25.16	51	39.37	36.7	34.05				

PCB PACKAGE SIZE (FOR REFERENCE ONLY)

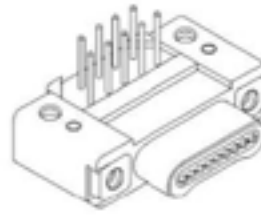

J63A-1E2-005-321-TH

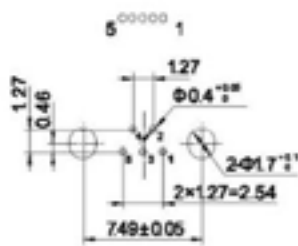

J63A-1E2-009-321-TH

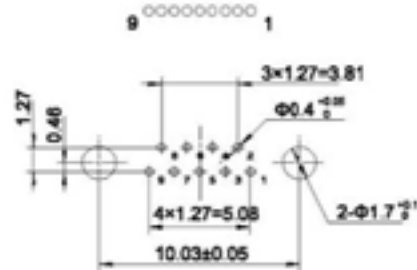

J63A-1E2-015-321-TH

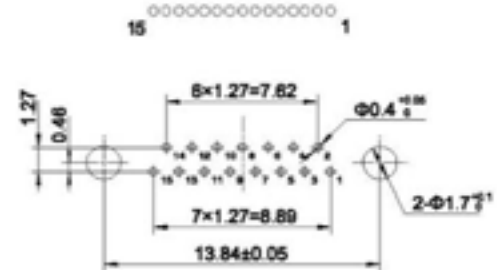

J63A-1E2-021-321-TH

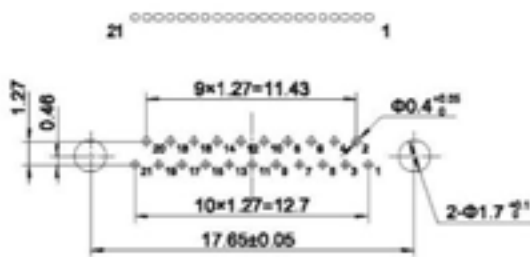

J63A-1E2-025-321-TH

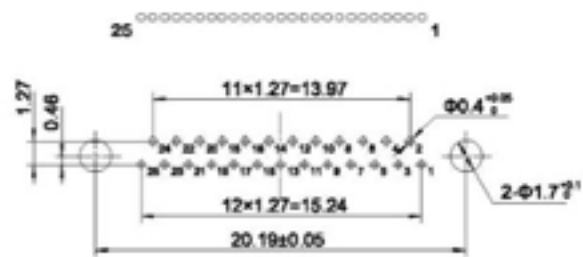

J63A-1E2-031-321-TH

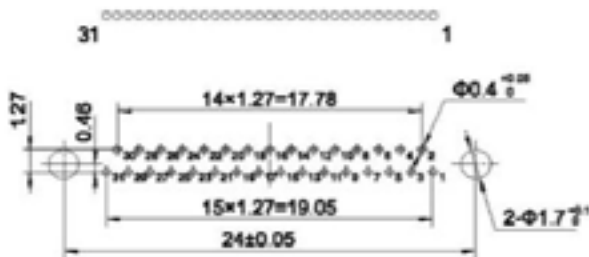

J63A-1E2-037-321-TH

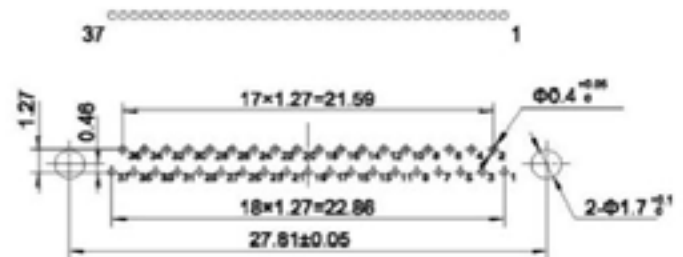

J63A-1E2-051-321-TH

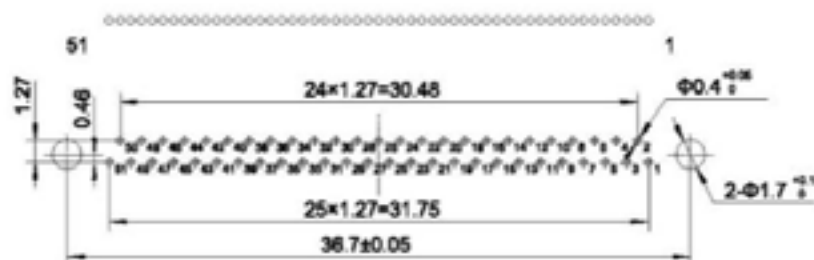

J63A BENDING INSERTED FLEXIBLE PCB PLUG WITH LOCK SCREW

HOW TO ORDER

J63A — 1 E 2 — 009 — 32 1 — JC
 ① ② ③ ④ ⑤ ⑥ ⑦ ⑧

Main code name	J63A	
Number of Contact's rows:	1 row	
Type of the connectors:	E	Right angle bending inserted plug
Shell plating:	2	Nickel plating
	3	Cadmium plating
	4	Stainless steel shell
Contact number:	005, 009, 015, 021, 025, 031, 037, 051	
Type of the contacts:	32	Bending inserted PCB male contact, the pin length is 2.77mm
	33	The pin length is 3.56mm
	34	The pin length is 4.37mm
Contact plating:	1	Gold plated
Type of locking parts:	JC	Lock screw (straight line groove)

BASIC FEATURES

- There are 3 specifications of the pin length, you have to customize the length which you need.
- This connector is free side and not mounted, it generally connects with socket which has coupling nut.
- The pin side is welded with flexible PCB.
- In general, it is necessary to use straight line groove lock screw (JC) which can be tightened by miniature screwdriver.



OVERALL DIMENSIONS

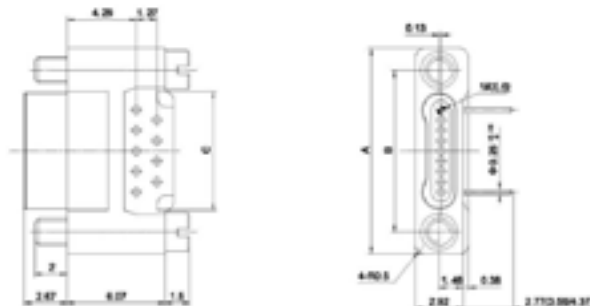

Type (Cores)	Size			Type (Cores)	Size			Type (Cores)	Size		
	A	B	C		A	B	C		A	B	C
5	10.16	7.49	4.84	9	12.7	10.03	7.38	15	16.51	13.84	11.19
21	20.32	17.65	15	25	22.86	20.19	17.54	31	26.67	24	21.35
37	30.48	27.81	25.16	51	39.37	36.7	34.05				

PCB PACKAGE SIZE (FOR REFERENCE ONLY)

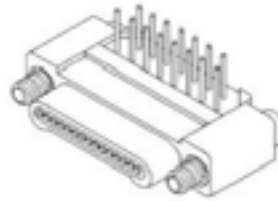

J63A-1E2-005-321-JC

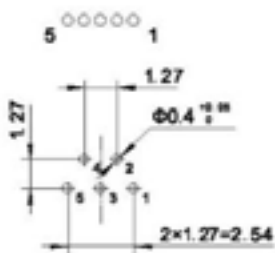

J63A-1E2-009-321-JC

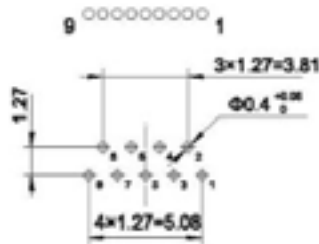

J63A-1E2-015-321-JC

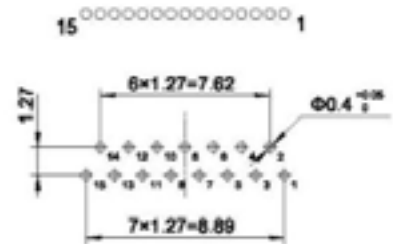

J63A-1E2-021-321-JC

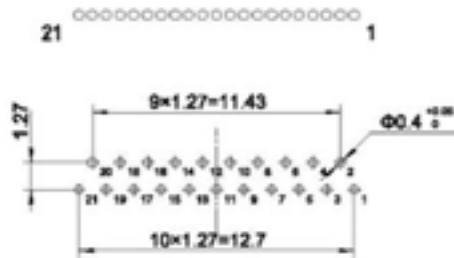

J63A-1E2-025-321-JC

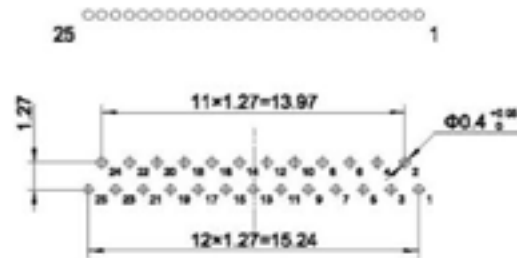

J63A-1E2-031-321-JC

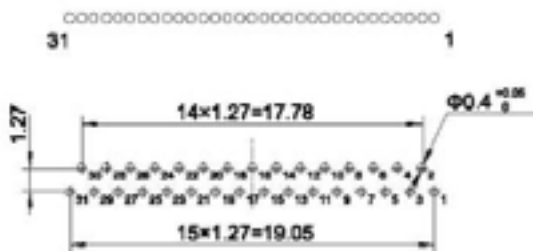

J63A-1E2-037-321-JC

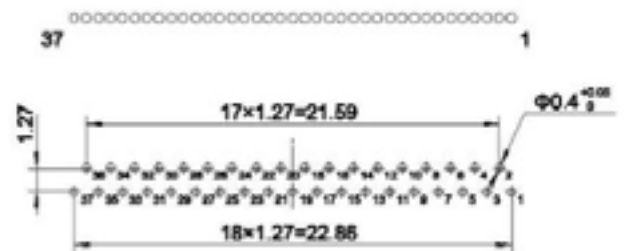

J63A-1E2-051-321-JC

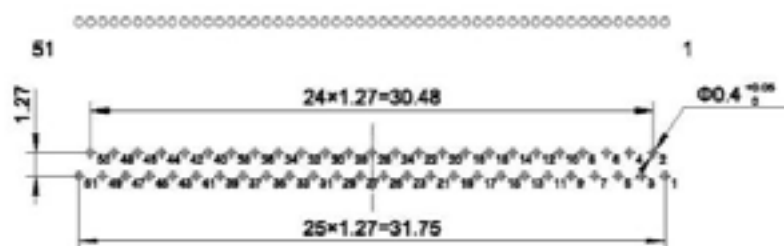

J63A BENDING INSERTED PCB SOCKET

HOW TO ORDER

$\frac{\text{J63A}}{\text{①}} - \frac{1}{\text{②}} \frac{\text{F}}{\text{③}} \frac{2}{\text{④}} - \frac{009}{\text{⑤}} - \frac{43}{\text{⑥}} \frac{1}{\text{⑦}} - \frac{\text{TH}}{\text{⑧}}$

Main code name	J63A	
Number of Contact's rows:	1 row	
Type of the connectors:	E	Right angle bending inserted plug
Shell plating:	2	Nickel plating
	3	Cadmium plating
	4	Stainless steel shell
Contact number:		005, 009, 015, 021, 025, 031, 037, 051
Type of the contacts:	43	Bending inserted PCB female contact, the pin length is 2.77mm.
	44	The pin length is 3.56mm
	45	The pin length is 4.37mm
Contact plating:	1	Gold plated
Type of locking parts:	TK	Coupling nut
	DK	Guide column

BASIC FEATURES

- There are three specifications of the pin length, you have to customize the length which you need.
- J63A-1F1-009-431-TH generally connects with plug which has lock screw.
- J63A-1F1-009-431-DK generally connects with plug which has guide column.

OVERALL DIMENSIONS

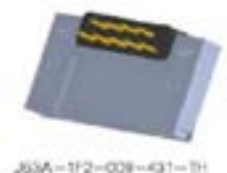
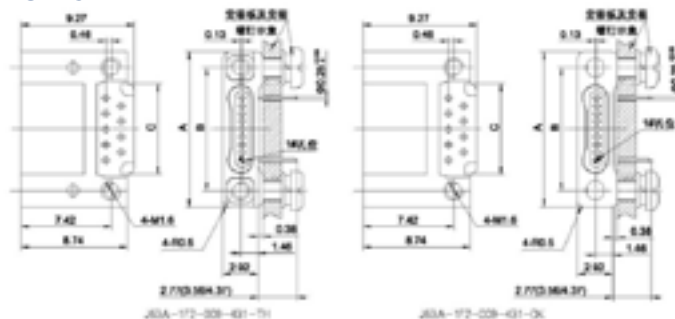

J63A-1F2-009-431-TH



J63A-1F2-009-431-DK

Type (Cores)	Size			Type (Cores)	Size			Type (Cores)	Size		
	A	B	C		A	B	C		A	B	C
5	10.16	7.49	4.84	9	12.7	10.03	7.38	15	16.51	13.84	11.19
21	20.32	17.65	15	25	22.86	20.19	17.54	31	26.67	24	21.35
37	30.48	27.81	25.16	51	39.37	36.7	34.05				

J63A STRAIGHT CUTTING PCB PLUG

HOW TO ORDER

$\frac{\text{J63A}}{\text{①}} - \frac{1}{\text{②}} \frac{\text{G}}{\text{③}} \frac{2}{\text{④}} - \frac{009}{\text{⑤}} - \frac{13}{\text{⑥}} \frac{1}{\text{⑦}} - \frac{\text{TH}}{\text{⑧}}$

Main code name	J63A	
Number of Contact's rows:	1 row	
Type of the connectors:	G	Straight cutting PCB plug
Shell plating:	2	Nickel plating
	3	Cadmium plating
	4	Stainless steel shell
Contact number:		005, 009, 015, 021, 025, 031, 037, 051
Type of the contacts:	13	Straight cutting PCB male contact, the pin length is 2.77mm.
	4	The pin length is 3.56mm.
	15	The pin length is 4.37mm
Contact plating:	1	Gold plated
Type of locking parts:	TH	Coupling nut
	DZ	Guide column

BASIC FEATURES

- There are three specifications of the pin length, you have to customize the length which you need.
- J63A-1G1-009-131-TH generally connects with screw which has lock screw.
- J63A-1G1-009-131-DK generally connects with socket which has guide column.

OVERALL DIMENSIONS

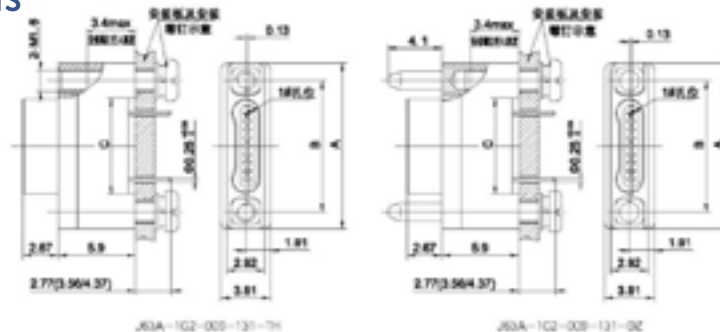

Type (Cores)	Size			Type (Cores)	Size			Type (Cores)	Size		
	A	B	C		A	B	C		A	B	C
5	10.16	7.49	4.84	9	12.7	10.03	7.38	15	16.51	13.84	11.19
21	20.32	17.65	15	25	22.86	20.19	17.54	31	26.67	24	21.35
37	30.48	27.81	25.16	51	39.37	36.7	34.05				

PCB PACKAGE SIZE (FOR REFERENCE ONLY)

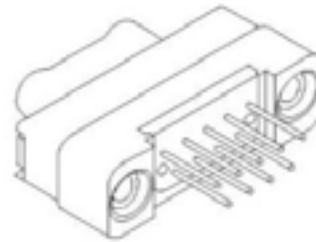

J63A-1G2-005-131-TH

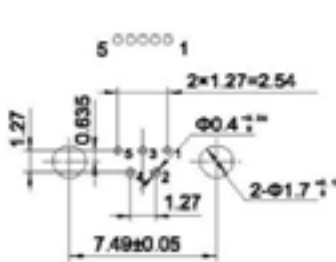

J63A-1G2-009-131-TH

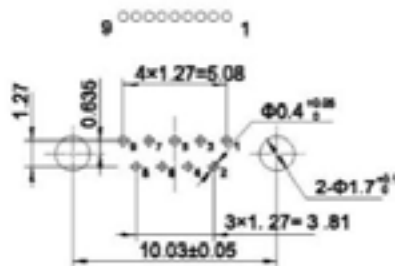

J63A-1G2-015-131-TH

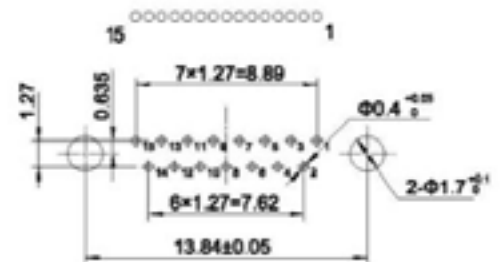

J63A-1G2-021-131-TH

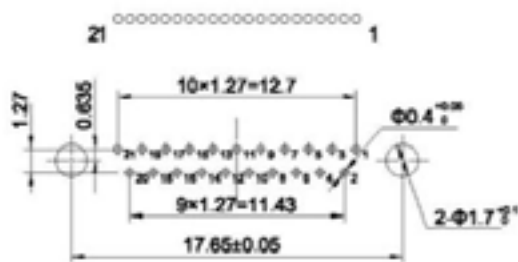

J63A-1G2-025-131-TH

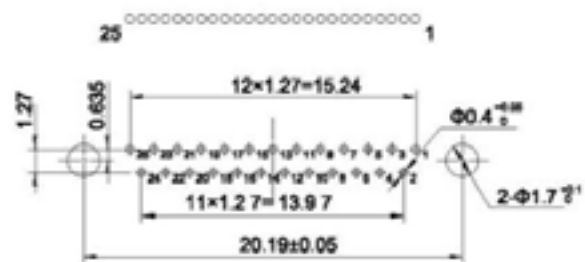

J63A-1G2-031-131-TH

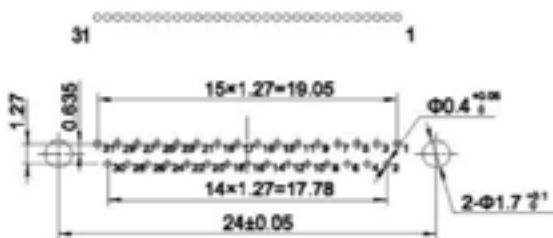

J63A-1G2-037-131-TH

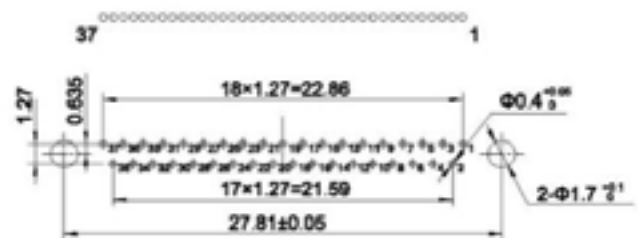

J63A-1G2-051-131-TH

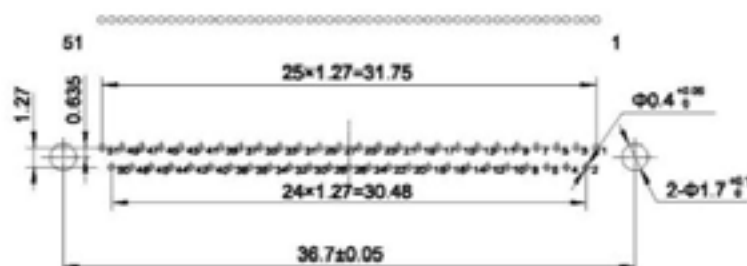

J63A STRAIGHT CUTTING PCB SOCKET

HOW TO ORDER

$\frac{\text{J63A}}{\text{①}} - \frac{1}{\text{②}} \frac{\text{H}}{\text{③}} \frac{2}{\text{④}} - \frac{009}{\text{⑤}} - \frac{23}{\text{⑥}} \frac{1}{\text{⑦}} - \frac{\text{TH}}{\text{⑧}}$

Main code name	J63A	
Number of Contact's rows:	1 row	
Type of the connectors:	H	Straight cutting PCB socket
Shell plating:	2	Nickel plating
	3	Cadmium plating
	4	Stainless steel shell
Contact number:		005, 009, 015, 021, 025, 031, 037, 051
Type of the contacts:	23	Straight cutting PCB female contact, the pin length is 2.77mm.
	24	The pin length is 3.56mm.
	25	The pin length is 4.37mm
Contact plating:	1	Gold plated
Type of locking parts:	TH	Coupling nut
	DZ	Guide hole

BASIC FEATURES

- There are three specifications of the pin length, you have to customize the length which you need.
- J63A-1H1-009-231-TH generally connects with plug which has lock screw.
- J63A-1H1-009-231-DK generally connects with plug which has guide column.



OVERALL DIMENSIONS

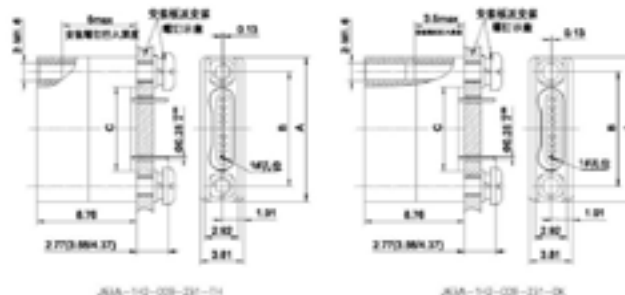

Type (Cores)	Size			Type (Cores)	Size			Type (Cores)	Size		
	A	B	C		A	B	C		A	B	C
5	10.16	7.49	4.84	9	12.7	10.03	7.38	15	16.51	13.84	11.19
21	20.32	17.65	15	25	22.86	20.19	17.54	31	26.67	24	21.35
37	30.48	27.81	25.16	51	39.37	36.7	34.05				

PCB PACKAGE SIZE (FOR REFERENCE ONLY)

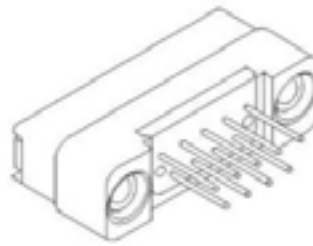
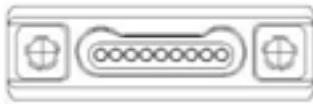

J63A-1H2-005-231-TH

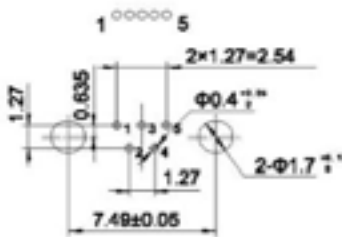

J63A-1H2-009-231-TH

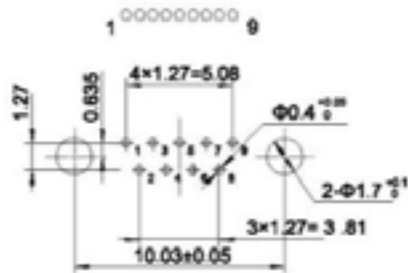

J63A-1H2-015-231-TH

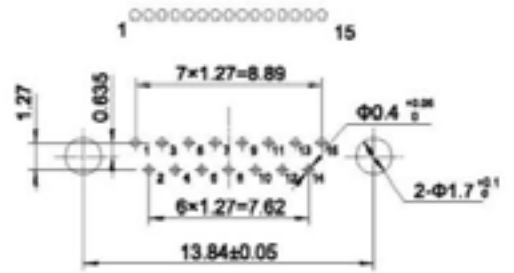

J63A-1H2-021-231-TH

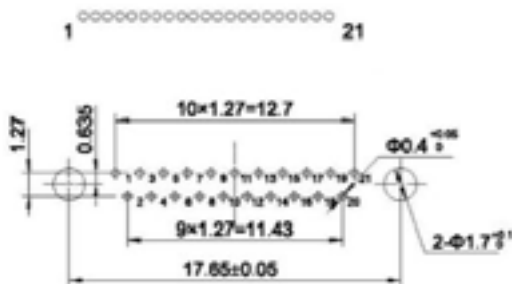

J63A-1H2-025-231-TH

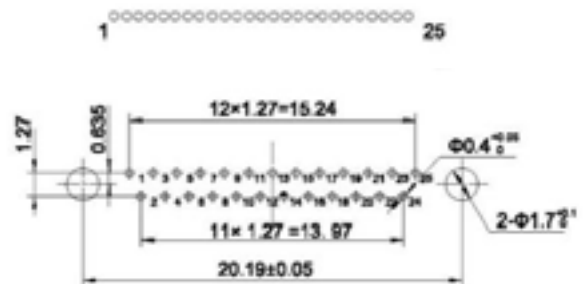

J63A-1H2-031-231-TH

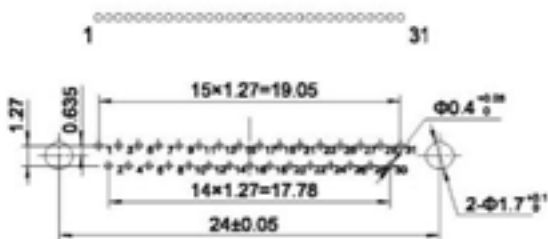

J63A-1H2-037-231-TH

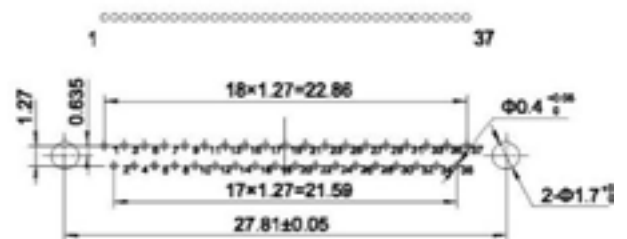

J63A-1H2-051-231-TH

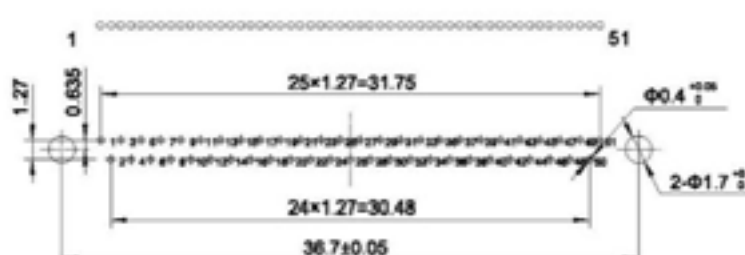



MATENG

SHENZHEN MATENG INTERCONNECTION TECHNOLOGY CO., LTD.

[HTTPS://MATENG.TECH/](https://mateng.tech/)